

# Pacific Street Village Streetscape Project



Public Meeting

July 11, 2023

Transportation,  
Traffic & Parking  
Department

**CITY OF  
STAMFORD**







# Transportation, Traffic & Parking Department

## Mission:

Ensure the safe and efficient movement of people and goods in the City of Stamford.





# Vision Zero

A commitment to eliminate traffic deaths

- One death is too many
- People make mistakes
- People are vulnerable
- Safety is proactive
- Reduce speeds



# Background

Project Idea from the 2018  
South End Neighborhood  
Study

## SOUTH END NEIGHBORHOOD STUDY



OCTOBER 23, 2018 FINAL REPORT PREPARED BY:  
COLLECTIVE FOR COMMUNITY, CULTURE AND ENVIRONMENT  
PENN PRAXIS  
LEVEL INFRASTRUCTURE  
LARISA ORTIZ ASSOCIATES

FOR THE CITY OF STAMFORD, LAND USE BUREAU





# Goals

What we're trying to achieve

- Increase safety
- Expand mobility options
- Support small businesses
- Increase greenspace and trees
- Increase lighting
- Slow speeds
- Enhance walking to train Station





# Details



- Raised intersection, bump outs, and new crosswalks at Pacific and Market
- Raised crosswalk at Towne Street
- New bioswales and street trees
- New pedestrian level lighting
- All work in ROW
- Estimated Cost:
  - \$938,687.00
  - 60% State Grant

# Timeline and Process

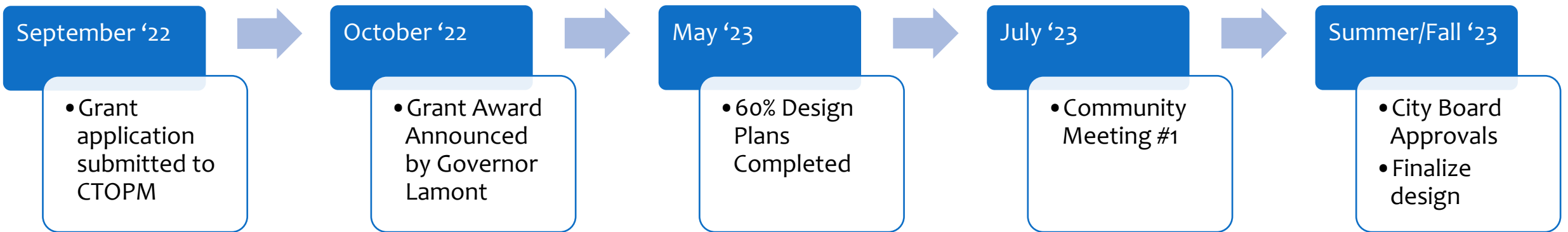

Construction tentatively  
Spring/Summer 2024

Additional community info meetings  
before construction starts

We are here

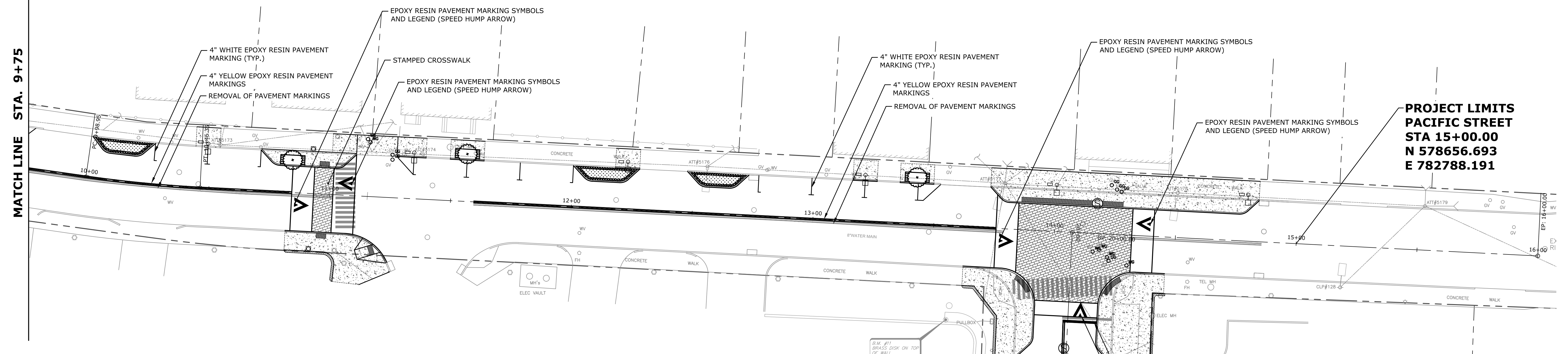
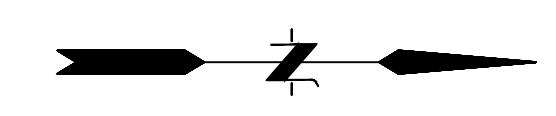

**PROJECT LIMITS  
PACIFIC STREET  
STA 7+00.00  
N 577860.936  
E 782715.571**

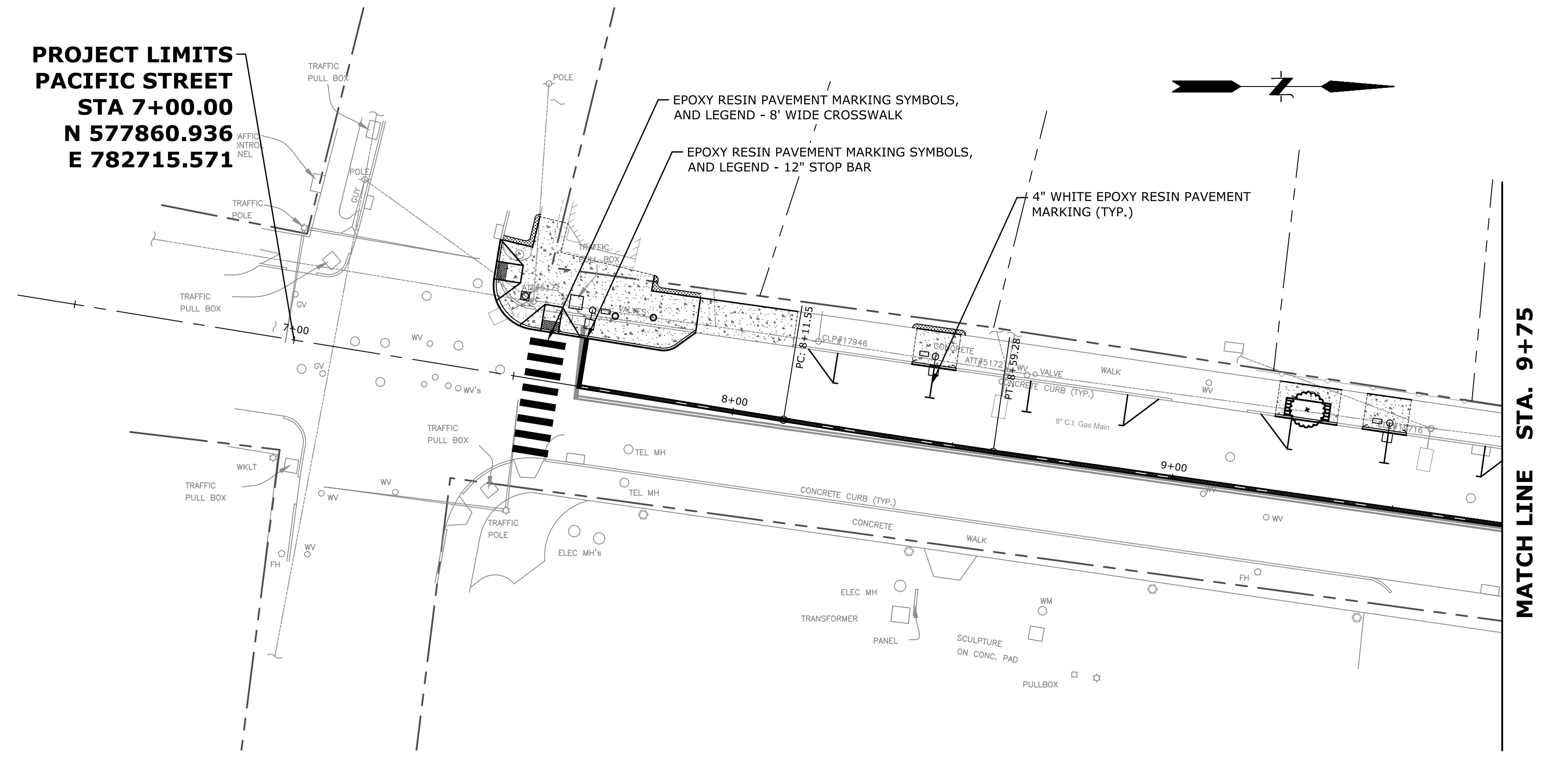
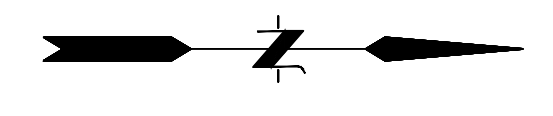

**PROJECT LIMITS  
MARKET STREET  
STA 21+00.00  
N 578559.062  
E 782883.356**

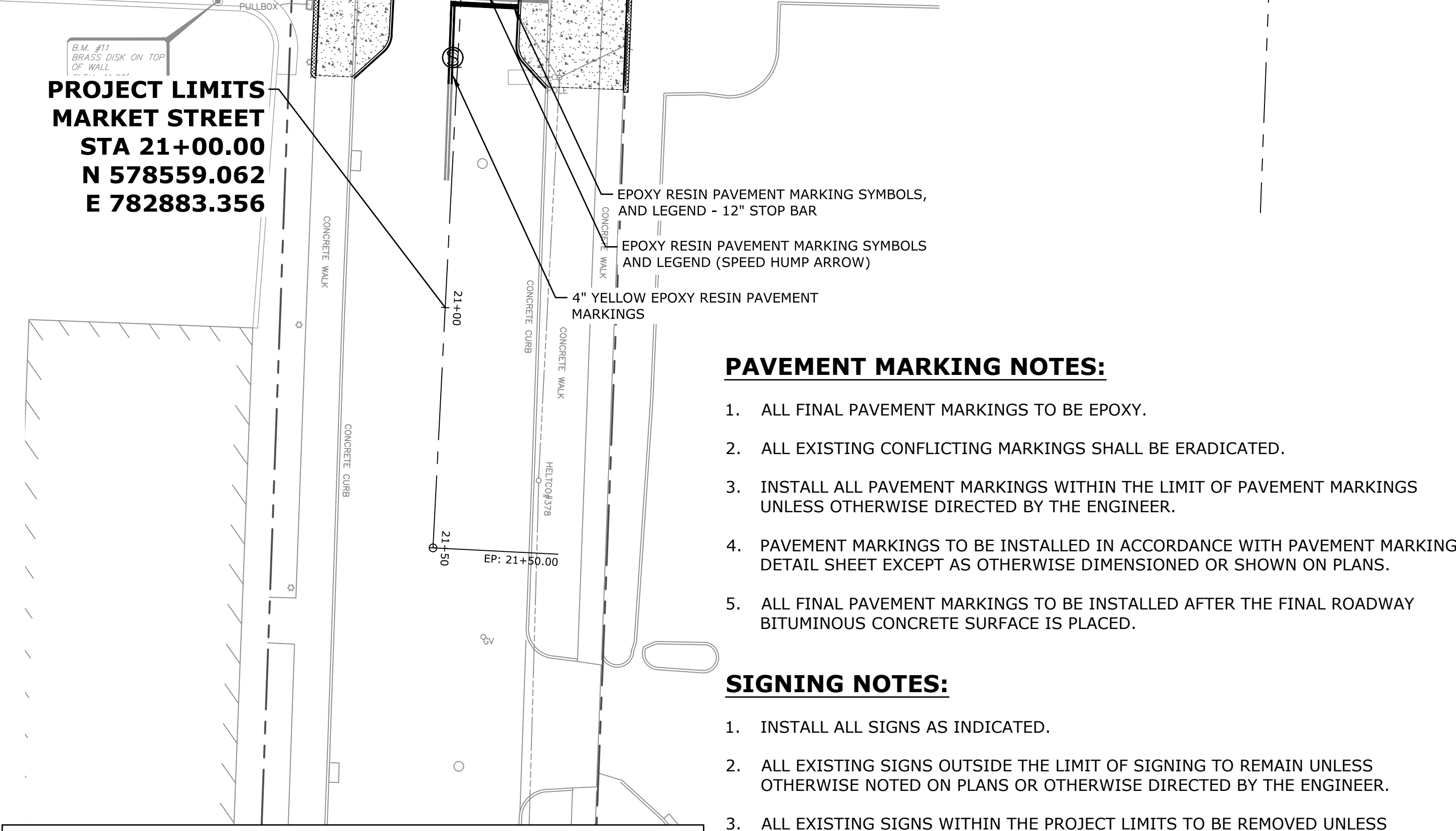

**PAVEMENT MARKING NOTES:**

1. ALL FINAL PAVEMENT MARKINGS TO BE EPOXY.
2. ALL EXISTING CONFLICTING MARKINGS SHALL BE ERADICATED.
3. INSTALL ALL PAVEMENT MARKINGS WITHIN THE LIMIT OF PAVEMENT MARKINGS UNLESS OTHERWISE DIRECTED BY THE ENGINEER.
4. PAVEMENT MARKINGS TO BE INSTALLED IN ACCORDANCE WITH PAVEMENT MARKING DETAIL SHEET EXCEPT AS OTHERWISE DIMENSIONED OR SHOWN ON PLANS.
5. ALL FINAL PAVEMENT MARKINGS TO BE INSTALLED AFTER THE FINAL ROADWAY BITUMINOUS CONCRETE SURFACE IS PLACED.

**SIGNING NOTES:**

1. INSTALL ALL SIGNS AS INDICATED.
2. ALL EXISTING SIGNS OUTSIDE THE LIMIT OF SIGNING TO REMAIN UNLESS OTHERWISE NOTED ON PLANS OR OTHERWISE DIRECTED BY THE ENGINEER.
3. ALL EXISTING SIGNS WITHIN THE PROJECT LIMITS TO BE REMOVED UNLESS OTHERWISE NOTED ON THE PLANS OR DIRECTED BY THE ENGINEER.
4. EXACT SIGN LOCATIONS TO BE DETERMINED BY THE ENGINEER.
5. WHEN A SIGN IS TO BE REPLACED THE EXISTING SIGN SHOULD NOT BE REMOVED UNTIL THE NEW REPLACEMENT SIGN IS INSTALLED.
6. SIGNS SHALL NOT BE PLACES LESS THAN 10 FEET FROM UTILITY POLES.

**MISC. NOTES:**

PROPOSED SIGNS TO BE SHOWN IN THE NEXT DESIGN SUBMISSION.

File: J:\DWG\20180287\C30\Civil\Plan\20180287\_C30\_FVT01.dwg Layout: PVT-01 Plotted: 2023-05-01 8:39 PM Saved: 2023-04-25 10:03 AM User: ACarson  
PC3: AUTOCAD PDF (GENERAL DOCUMENTATION)PC3\_STB/CTB: FO STB  
LAYER STATE:

No.	DATE	DESCRIPTION	DESIGNER	REVIEWER

SEAL

SEAL

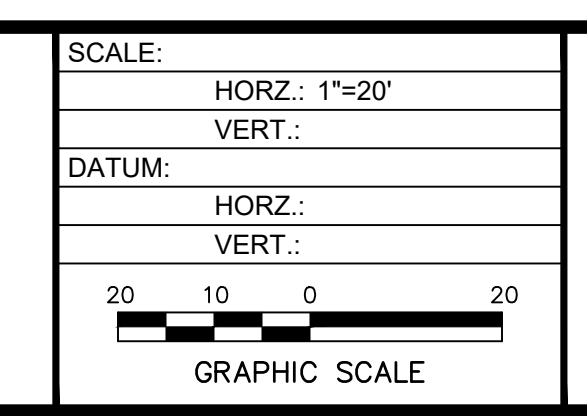

**FUSS & O'NEILL**  
146 HARTFORD ROAD  
MANCHESTER, CONNECTICUT 06040  
860.646.2469  
www.fando.com

CITY OF STAMFORD  
PAVEMENT MARKING & SIGNING PLANS  
PACIFIC STREET VILLAGE STREETScape DESIGN  
STAMFORD CONNECTICUT

PROJ. No.: 20180287.C30  
DATE: MAY 2023  
**PVT-01**





# Thank You

Luke Bittenwieser



203-977-1742



Lbittenwieser@StamfordCT.gov



StamfordCT.gov

