

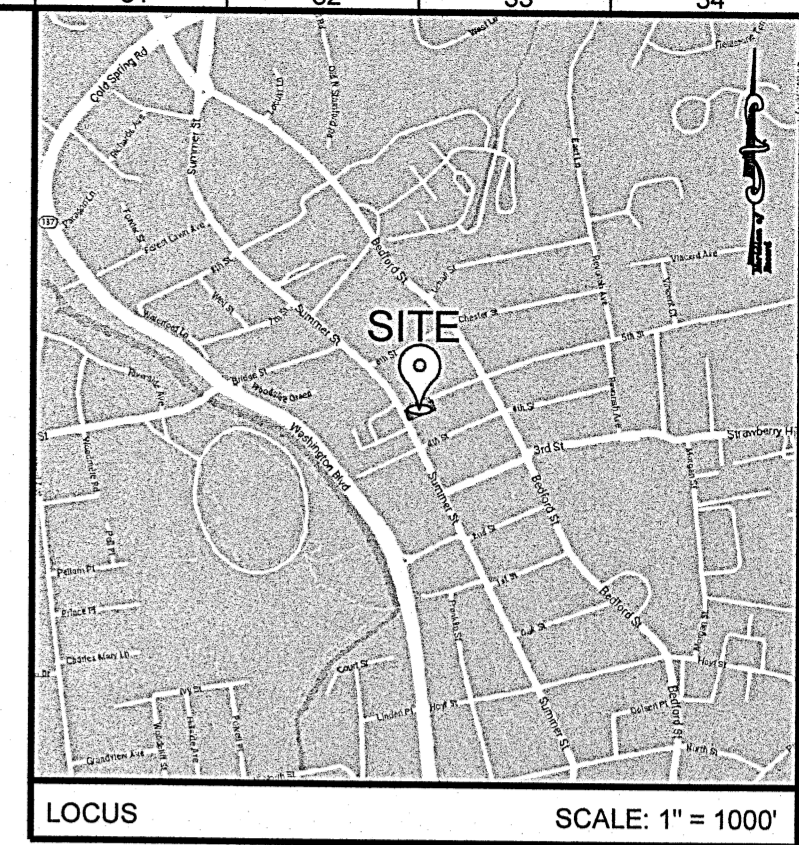

ZONE: C-L



SSMH #1
RIM EL. = 30.95
8" DUCTILE PIPE INV. IN = 23.25 NW
8" DUCTILE PIPE INV. IN = 23.25 NE
8" DUCTILE PIPE INV. OUT = 22.95 SW

SSMH #2
RIM EL. = 31.06
12" DUCTILE PIPE INV. IN = 22.86 NE
12" DUCTILE PIPE INV. IN = 22.86 W
12" DUCTILE PIPE INV. IN = 22.76 NW
12" DUCTILE PIPE INV. OUT = 22.76 SW

SSMH #3
RIM EL. = 30.92
12" PIPE INV. IN = 21.92 NE
12" DUCTILE F.L. = 21.72 NW TO SE

CB #1
RIM EL. = 30.86
12" PIPE INV. OUT = 28.36
SUMP EL. = 26.86

CB #2
RIM EL. = 30.65
12" PIPE INV. OUT = 28.05
SUMP EL. = 24.15

DMH #1
RIM EL. = 30.80
12" PVC INV. IN = 27.20 NW
18" PVC INV. IN = 25.00 NE
36" RCP INV. IN = 18.40 NE
36" RCP INV. OUT = 18.20 SW

DMH #2
RIM EL. = 30.87
4" PVC INV. IN = 23.27
18" RCP INV. IN = 21.67 NW
18" RCP INV. OUT = 21.76 SE

CB #4
RIM EL. = 30.64
12" PIPE INV. OUT = 28.14
SUMP EL. = 24.94

BENCH MARK
TELEPHONE MANHOLE
TOP OF COVER
EL. = 31.04
(NAD83 DATA)

5TH STREET

SUMMER STREET

5TH STREET

STREET

(50 FT. R.O.W. WIDTH)

EXISTING 2 STORY BUILDING

Part of LOT No. 1 (R.M. No. 64 SLR)

Lot Area = 7043.27 Sq. Ft. (0.16 Ac.)

LEGEND

- 85- EXISTING MAJOR CONTOURS
- 96- EXISTING MINOR CONTOURS
- x 94.37 SPOT ELEVATIONS
- OHW OVERHEAD WIRE
- MANHOLE
- HYDRANT
- WATER VALVE
- GAS VALVE
- UTILITY POLE

ABBREVIATIONS

- INV. INVERT ELEVATION
- EL. ELEVATION
- N/F NOW OR FORMERLY
- R.O.W. RIGHT OF WAY
- DMH DRAINAGE MANHOLE
- SSMH SANITARY SEWER MANHOLE
- RCP REINFORCED CONCRETE PIPE
- F.L. FLOW LINE
- COMP. COMPUTED

#004-23

SURVEY NOTES:

This survey has been prepared in accordance with sections 20-300b-1 thru 20-300b-20 of the regulations of Connecticut state agencies and the "Standards for Surveys and Maps in the State of Connecticut" as adopted by the Connecticut Association of Land Surveyors, Inc. as a Zoning Location Survey the boundary determination category of which is a dependent resurvey conforming to horizontal accuracy class A-2, vertical accuracy class T-2.

Reference is made to book 3743 at page 245 and designated as part of Lot No. 1 on a certain map entitled "Map of Building Property of Ayres Brothers and Hoyt in Stamford, Conn." filed in the office of City Clerk of City of Stamford as Map No. 64.

Property subject to any and all public or private restrictive covenants, declarations and/or easements of record, if any.

This map is based on a field survey conducted by Ahneman Kirby, LLC on August 4, 2021.

Contours and elevation shown are based on North American Vertical Datum of 1988 (NAVD88).

Underground utilities, facilities and structures are not shown hereon. The locations of any underground utilities shown hereon are approximate only. Additionally there are underground utilities the locations of which are currently unknown. Any party utilizing the utility information and data depicted on this survey shall contact the "CALL BEFORE YOU DIG" phone number at 800-922-4455 a minimum of forty eight (48) hours prior to any construction activities to verify the location of any and all underground utilities.

Dimensions shown from structures to property lines are not intended to be used for construction of fences, structures or other site improvements.

It is the requirement of the owner and/or his/her legal representative to advise Ahneman Kirby, LLC of any and/or all deed restrictions on the subject property that may preclude further development and/or construction thereon.

TO THE BEST OF MY KNOWLEDGE AND BELIEF, THIS MAP IS SUBSTANTIALLY CORRECT AS NOTED HEREON.

Thomas G. Ahneman
Thomas G. Ahneman, P.E., L.S. #14634
08/16/2021
DATE

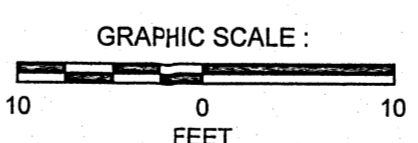

PRINT INVALID WITHOUT SEAL AND ORIGINAL SIGNATURE

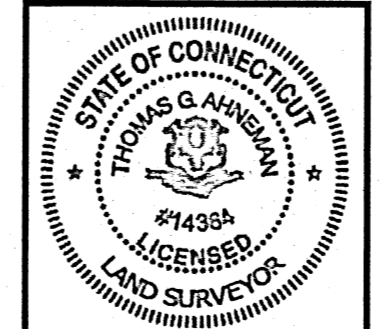

REV. #	REV. DESCRIPTION	DATE

AHNEMANKIRBY
ENGINEERS • SURVEYORS • PLANNERS
SINCE 1871
1171 East Putnam Avenue, Riverside, CT 06878
Tel: 203.869.7707 • Fax: 203.869.4805
www.ahnemankirby.com

PREPARED FOR:
DANIEL KOLICH
1911 Summer Street, Stamford, CT 06905
(Tax ID: 001-52426)
TOPOGRAPHY SURVEY
TP-1

Date:	August 16, 2021
Scale:	1" = 10'
Drawn/Checked By:	KBF, NKM / TGA
Book #:	258:135
Job #:	21-147-06905
Reference:	06905