

DRAFT 7-24-19

LEGEND

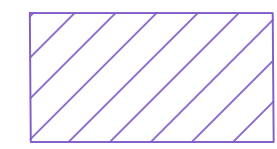

NOTE-01-
REMOVE ASBESTOS CEILING PLASTER ABOVE NON-ASBESTOS DROP CEILING
CONDUCT WORK WITHIN NEGATIVE PRESSURE CONTAINMENT WITH CONTIGUOUS THREE STAGE WORKER DECONTAMINATION UNIT AND TWO STAGE WASTE LOAD OUT DECONTAMINATION UNIT



NOTE -02-
REMOVE ASBESTOS 9x9 ORANGE FLOOR TILES AND UNDERLAYMENT
CONDUCT WORK WITHIN NEGATIVE PRESSURE TWO LAYER CONTAINMENT WITH CONTIGUOUS THREE STAGE WORKER DECONTAMINATION UNIT AND TWO STAGE WASTE LOAD OUT DECONTAMINATION UNIT

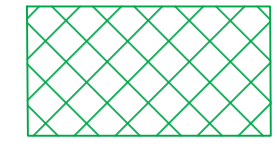

NOTE -03-
OCCUPIED STUDENTS
STUDENTS PARTICIPATING IN SUMMER SCHOOL WITHIN THE GYMNASIUM AND 1971 BUILDINGS ON LEVEL "B" FLOOR AS WELL AS STUDENTS ENTERING MAIN OFFICE AREA ON LEVEL "C" FLOOR TO REGISTER FOR SCHOOL



APPROXIMATE SPRINKLER HEAD LOCATION



HARD BARRIER

AREA SHOWN

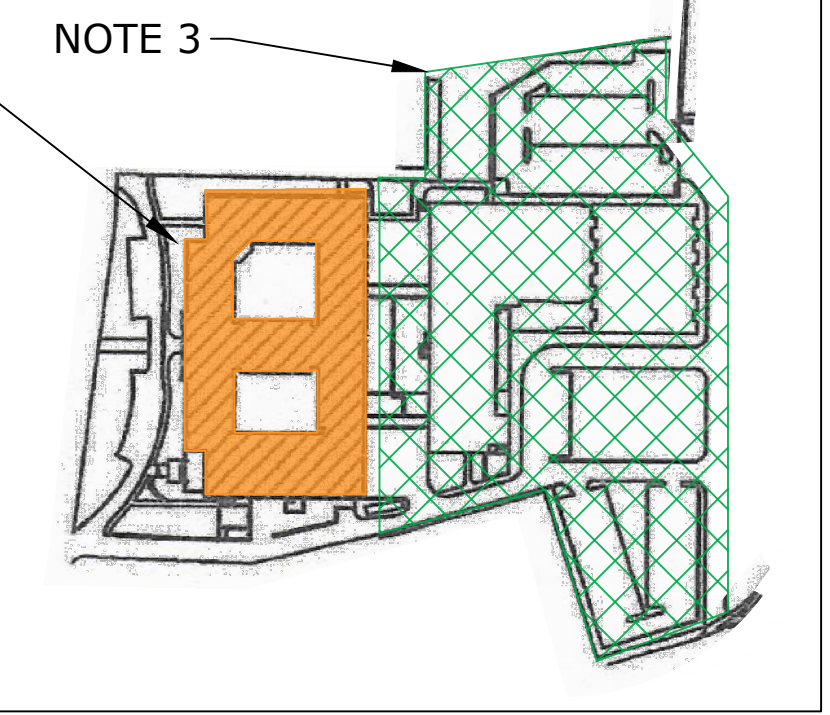

LEVEL "B" FLOOR PLAN

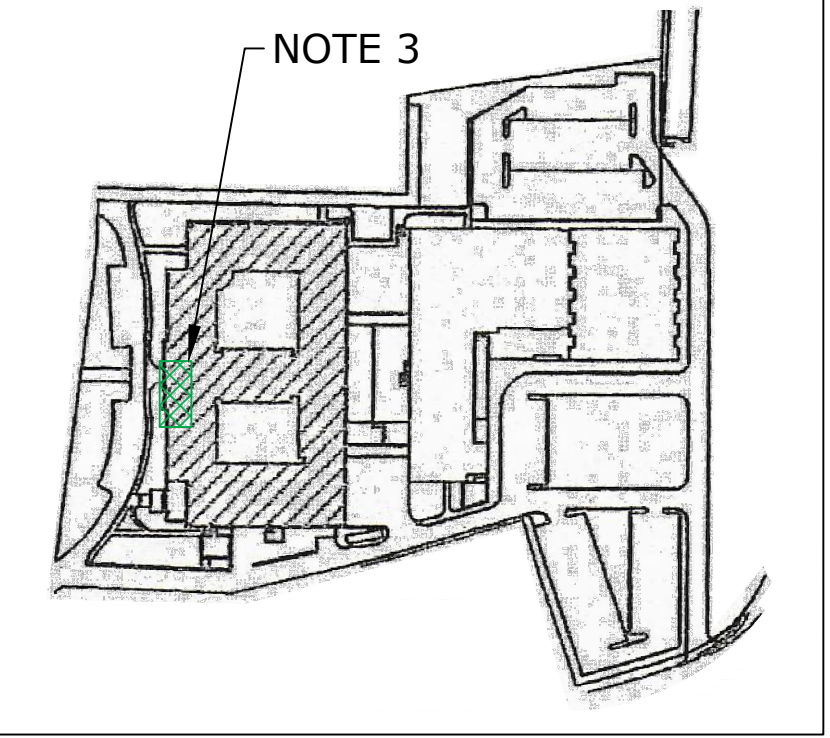

LEVEL "C" FLOOR PLAN

PHASE ONE WORK PLAN

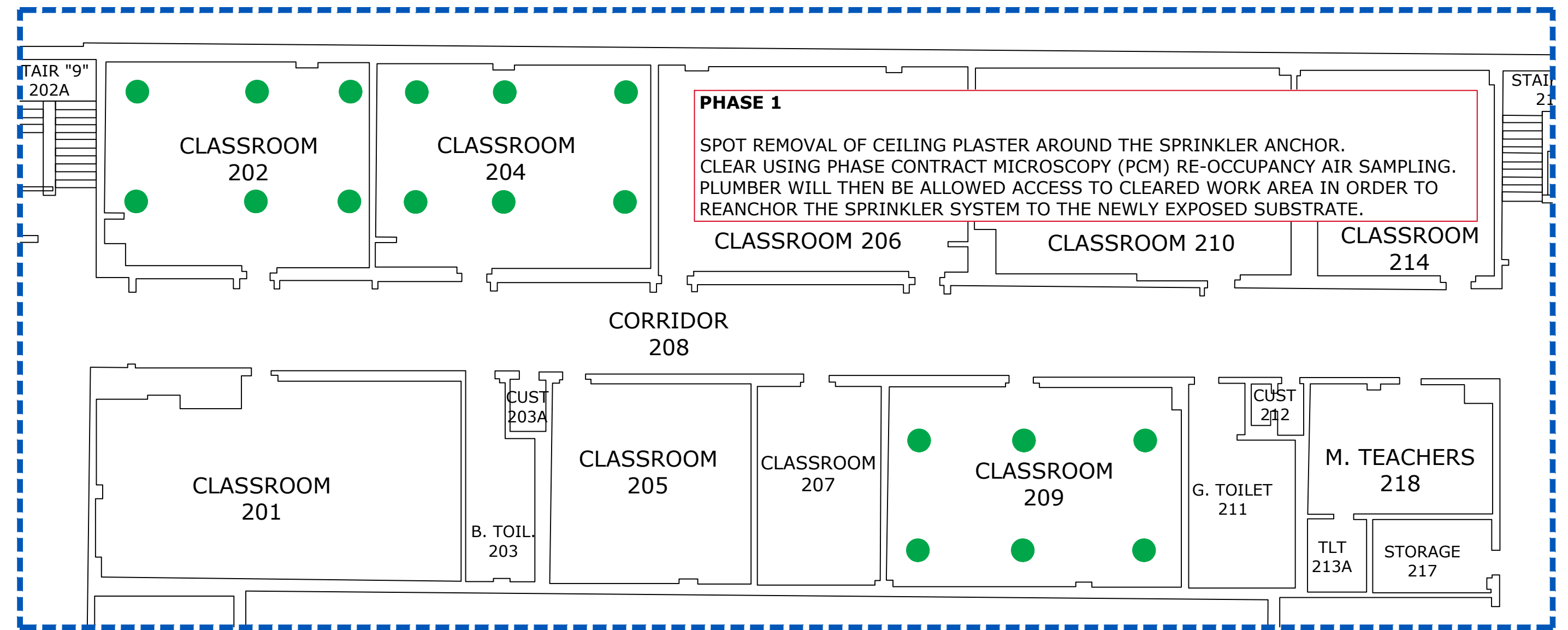

PHASE TWO WORK PLAN

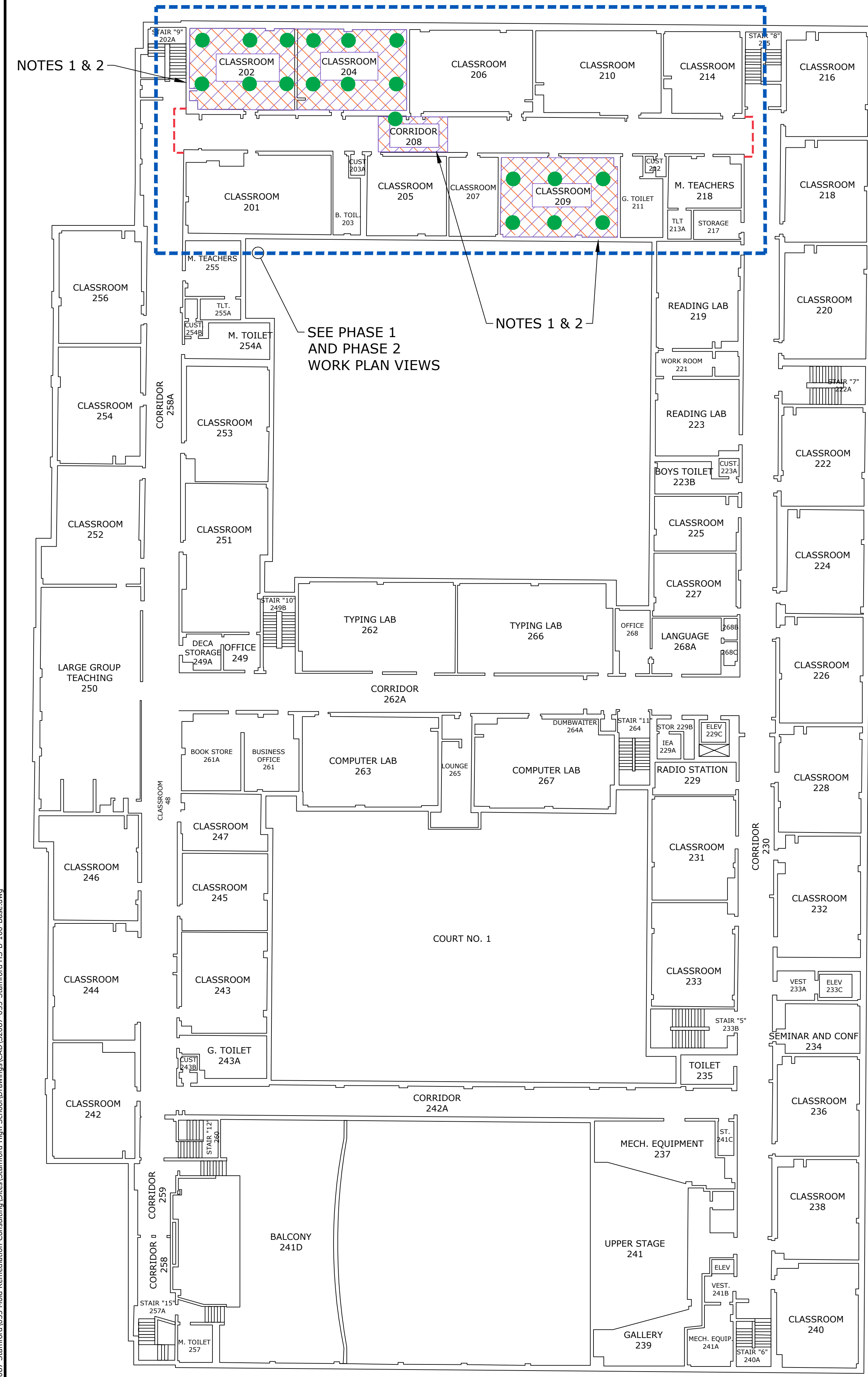
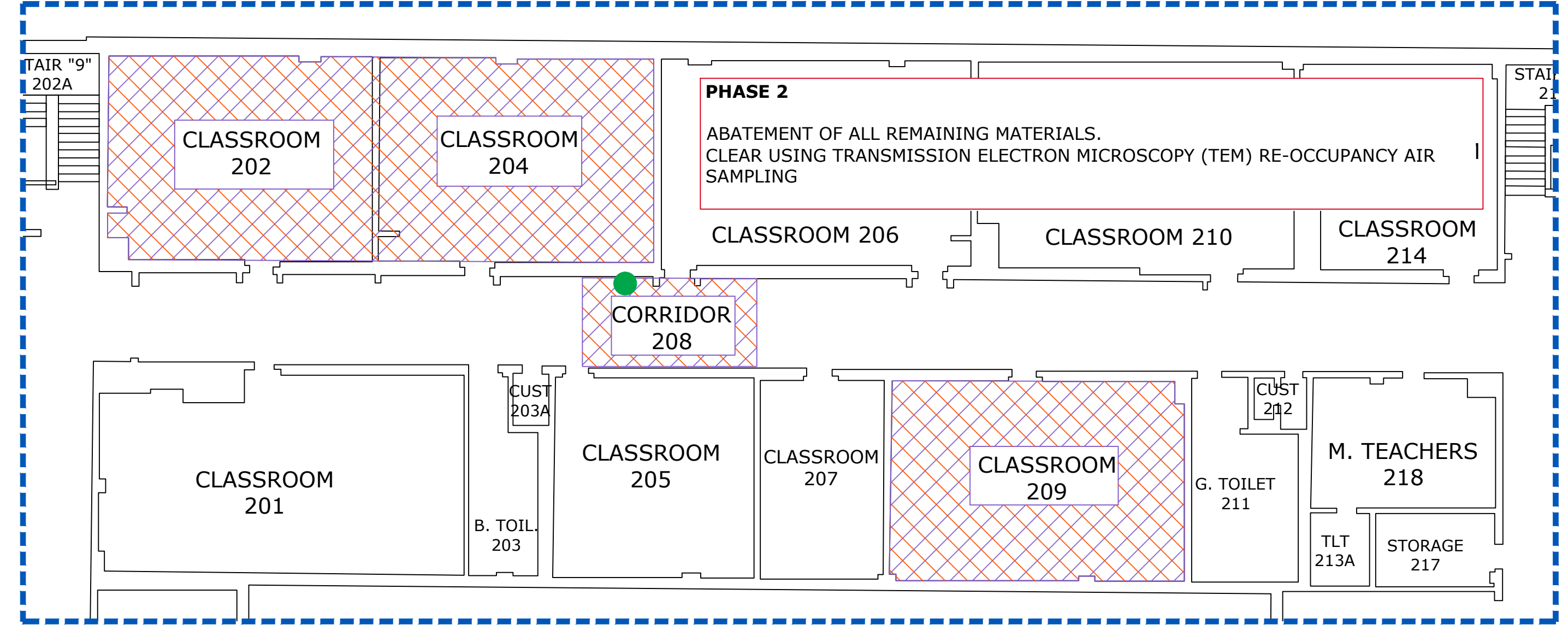

LEVEL "B" FLOOR

Stamford High School Mold Remediation Consultation

City of Stamford

Stamford, CT

MARK	DATE	DESCRIPTION
PROJECT NO:	S2087-033	
DATE:	7/24/2019	
FILE:	S2087-033-Stamford HS-B-100-Base.dwg	
DRAWN BY:	JFA	
CHECKED:	XX	
APPROVED:	XX	

Summer Work Plan Level "B" Floor

SCALE: NOT TO SCALE

Last Saved: 7/24/2019 10:32:37 AM By: JAdomitt
 Plotted On: 7/24/2019 10:32:37 AM
 Tighe & Bond: S:\S2087-Stamford High School\Drawings\CAD\S2087-033-Stamford HS-B-100-Base.dwg