

171 HENRY STREET:  
 PROPERTY AREA=5,135 SF  
 GREENSPACE AREA=1,848 SF  
 BUILDING COVERAGE=1,035 SF  
 % GREENSPACE=36.0%  
 % BUILDING COVERAGE=20.2%

670 PACIFIC STREET:  
 PROPERTY AREA=6,698 SF  
 GREENSPACE AREA=2,060 SF  
 BUILDING COVERAGE=2,559 SF  
 % GREENSPACE=30.7%  
 % BUILDING COVERAGE=38.2%

648 PACIFIC STREET:  
 PROPERTY AREA=8,694 SF  
 GREENSPACE AREA=1,387 SF  
 BUILDING COVERAGE=3,250 SF  
 % GREENSPACE=15.9%  
 % BUILDING COVERAGE=37.4%

686 & 690 PACIFIC STREET:  
 PROPERTY AREA=20,806 SF  
 GREENSPACE AREA=2,072 SF  
 BUILDING COVERAGE=16,619 SF  
 % GREENSPACE=10.0%  
 % BUILDING COVERAGE=80.0%

V-C ZONE CALCULATIONS:  
 AREA=36,196 SF  
 GREENSPACE AREA=5,519 SF  
 BUILDING COVERAGE=22,428 SF  
 % GREENSPACE=15.25%  
 % BUILDING COVERAGE=61.96%

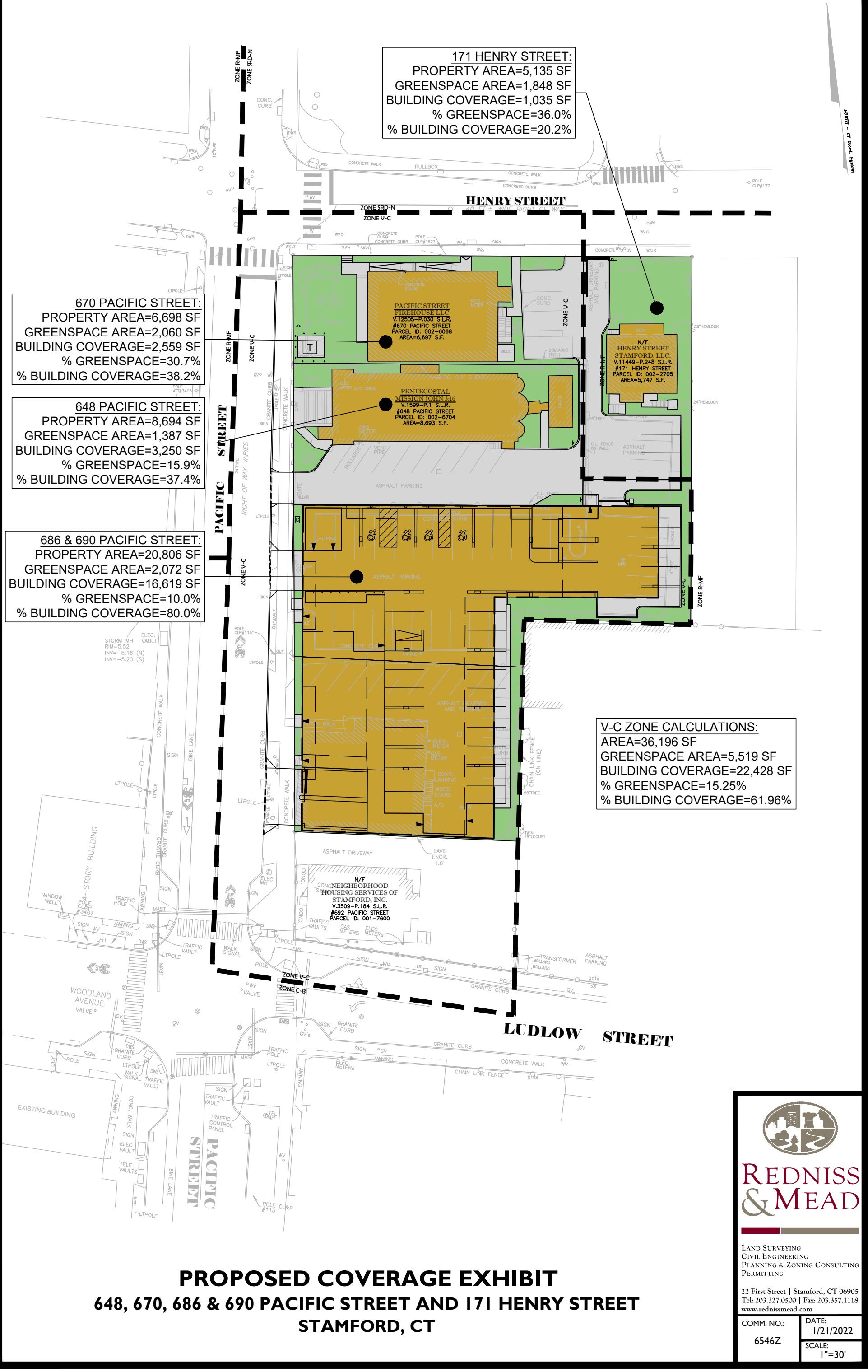

**PROPOSED COVERAGE EXHIBIT**

**648, 670, 686 & 690 PACIFIC STREET AND 171 HENRY STREET  
 STAMFORD, CT**



**REDNISS  
& MEAD**

LAND SURVEYING  
 CIVIL ENGINEERING  
 PLANNING & ZONING CONSULTING  
 PERMITTING

22 First Street | Stamford, CT 06905  
 Tel: 203.327.0500 | Fax: 203.357.1118  
 www.rednissmead.com

COMM. NO.: 6546Z	DATE: 1/21/2022
	SCALE: 1"=30'

1/21/2022 2:31 PM H:\jobfiles\216000\6500\6546\6546z.dwg Master5 (NAVDB88).dwg