

April 19, 2021

VIA E-MAIL & HAND DELIVERY

Ms. Vineeta Mathur
Senior Planner
City of Stamford
888 Washington Blvd.
Stamford, CT 06901
vmathur@stamfordct.gov

**RE: Appl. 221-08: 12 Research Drive, Stamford, Connecticut (the “Property”)
Revised Site Plan**

Dear Ms. Mathur:

On behalf of the applicants, Stamford Research Drive LLC and FFD West LLC (collectively, the “Applicants”), in connection with the above-captioned pending application, enclosed please find a revised site plan titled “Sheet: SD-4.3.1 Proposed Site Plan” prepared by L’Arc Architects LLC, dated April 16, 2021. I have enclosed two (2) full size copies and eight (8) reduced size copies (18”x24”). This revised plan incorporates comments received from the Stamford Department of Transportation, Traffic and Parking.

It would be appreciated if you could include this revised plan in the application file. If you have any questions about this application or require additional information, please do not hesitate to contact me.

Sincerely,



Meaghan M. Miles

Cc: Development Team

Enclosure

RESEARCH DRIVE

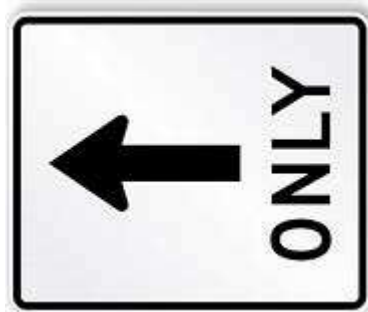
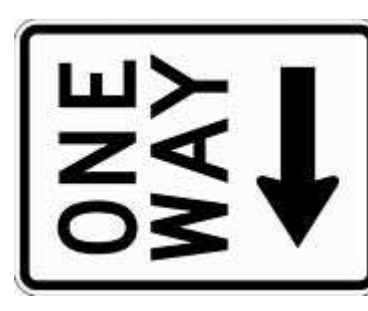
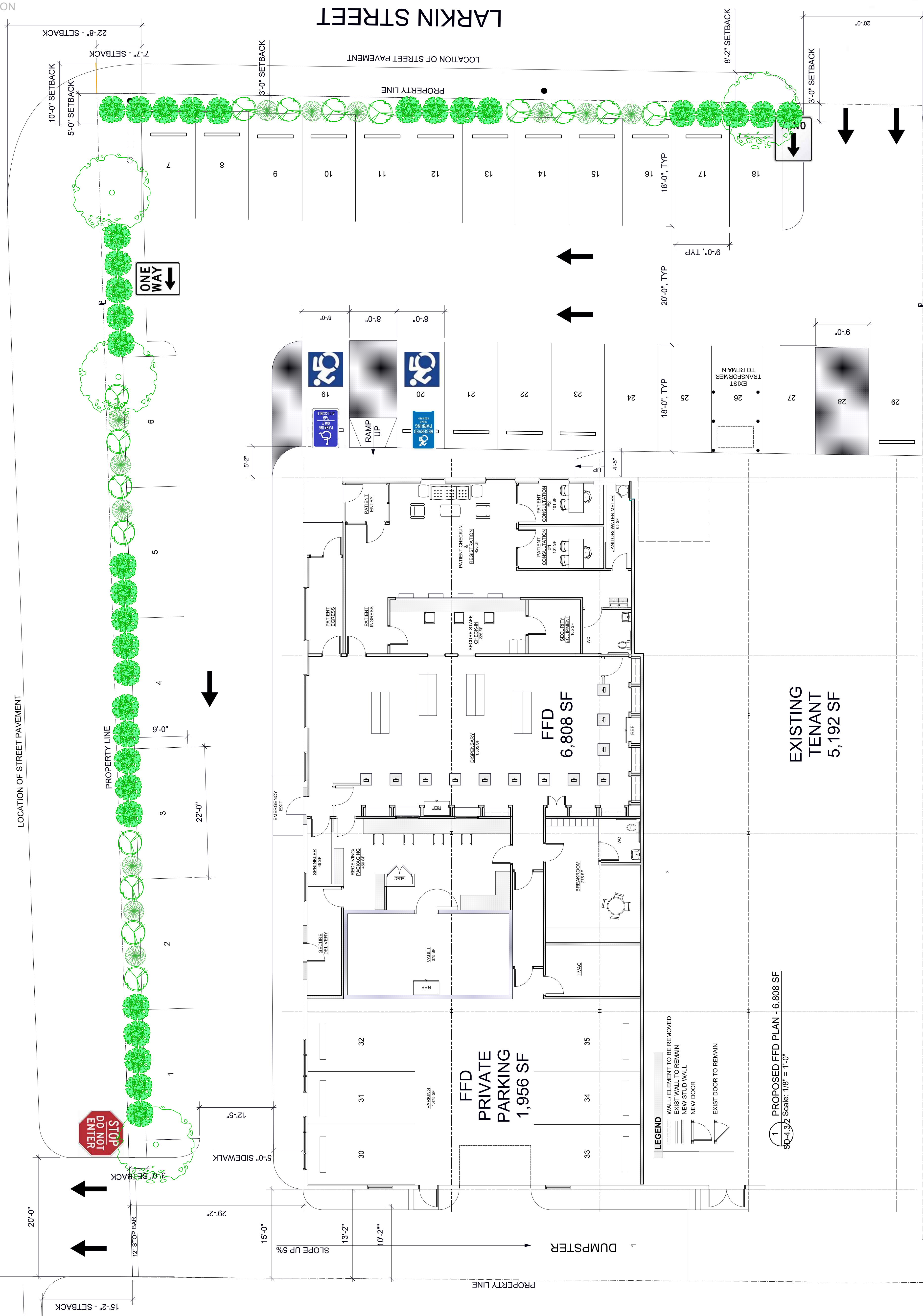

LEGEND

- WALL/ELEMENT TO BE REMOVED
- EXIST WALL TO REMAIN
- NEW STUD WALL
- NEW DOOR
- EXIST DOOR TO REMAIN

1 PROPOSED FFD PLAN - 6,808 SF
 SD-4.3.2 Scale: 1/8" = 1'-0"

1 PROPOSED ACME PLAN
 SD-4.3.4 Scale: 1/8" = 1'-0"