

LEGEND

- REMOVE DRYWALL/ASBESTOS TAPING COMPOUND FROM FLOOR TO FOUR FEET IN CUSTODIAN CLOSET.
- REMOVE DRYWALL/ASBESTOS TAPING COMPOUND ENTIRELY IN NURSE'S ROOM (REMOVE OUTSIDE CORNER EDGE AND ASBESTOS TAPING COMPOUND TO FACILITATE RESTORATION).
- CLEAN AND DISINFECT AREA.

GENERAL NOTES

ASBESTOS DRYWALL WORK SHALL BE CONDUCTED WITHIN NEGATIVE PRESSURE ASBESTOS CONTAINMENTS.
NON-ASBESTOS DRYWALL REMOVAL WORK SHALL BE CONDUCTED WITHIN ONE LAYER NEGATIVE PRESSURE CONTAINMENTS.

DRAFT - NOT FOR CONSTRUCTION

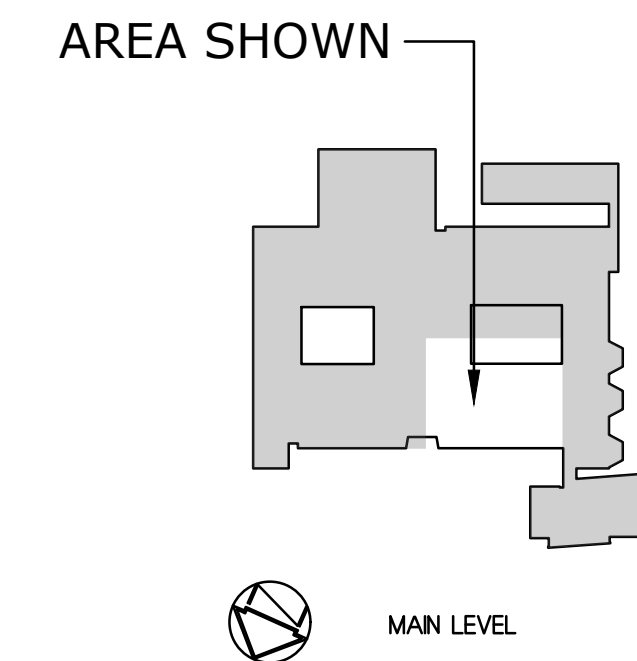

Northeast Elementary School
City of Stamford
Stamford, CT

| MARK | DATE | DESCRIPTION |
|-------------|--------------------------------|-------------|
| PROJECT NO: | S2087 | |
| DATE: | 2/5/2019 | |
| FILE: | Northeast Mold Remediation.dwg | |
| DRAWN BY: | WAC | |
| CHECKED: | XX | |
| APPROVED: | XX | |

AREA 2

SCALE: NOT TO SCALE

FIGURE 3.2