

SECOND FLOOR

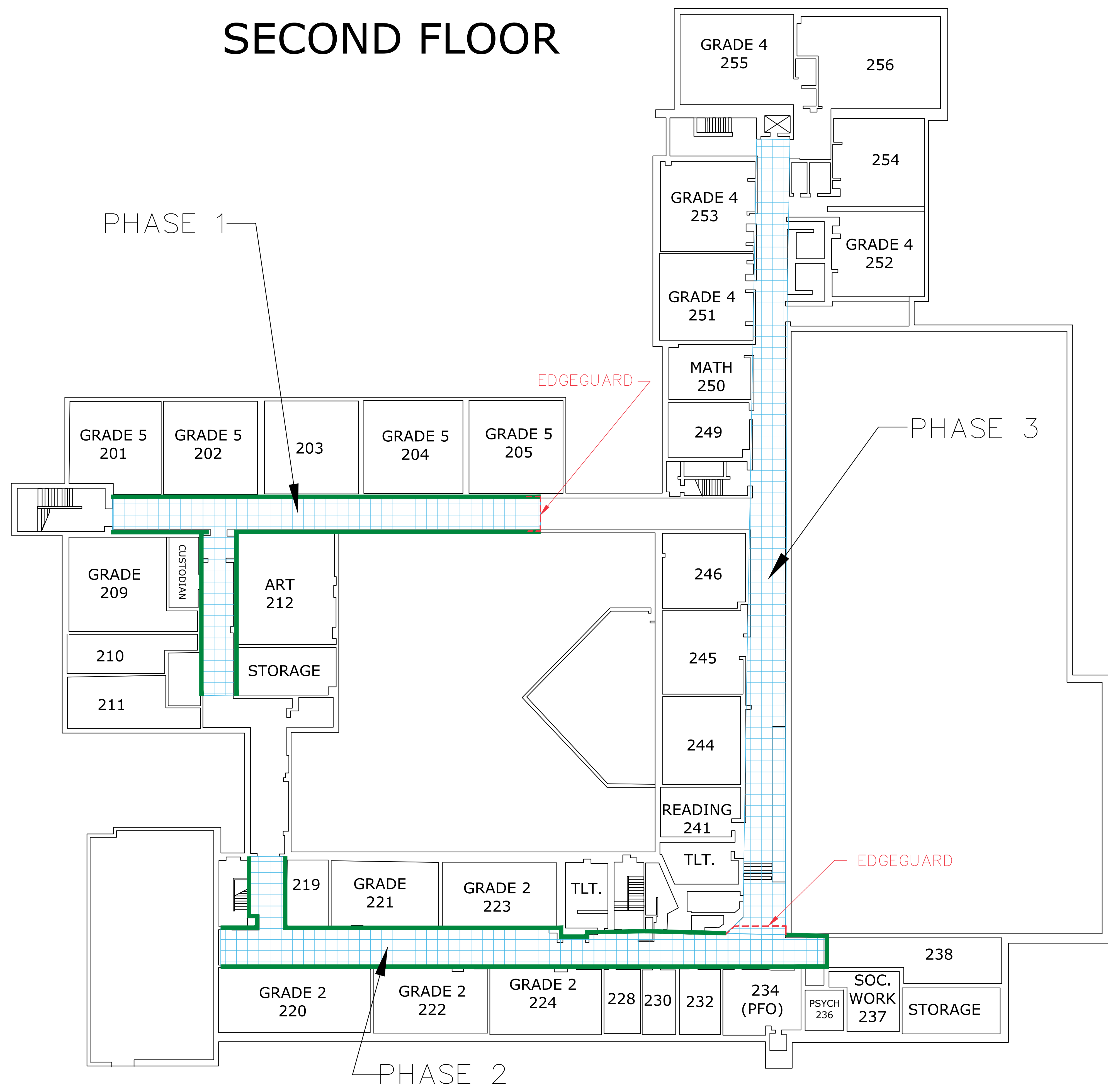

NOTES:

- PHASE 1 - CORRIDOR AREA ROOMS 205-211**
- SET UP EDGEGUARD AT CORRIDOR ENTRANCE
 - SET UP CONTAINMENT AND NEGATIVE AIR MACHINE
 - REMOVE APPROXIMATELY 3,100 SF OF VINYL WALL PAPER
 - INSPECT DRYWALL AND REMOVE DRYWALL WHERE NEEDED
 - INSTALL OBSERVATION HOLES IN SELECT LOCATIONS
 - REMOVE 17 CEILING TILES
 - SPRAY AND CLEAN WITH EPA APPROVED FUNGICIDE
- PHASE 2 - CORRIDOR AREA ROOMS 238-220**
- SET UP EDGEGUARD AT CORRIDOR ENTRANCE
 - SET UP CONTAINMENT AND NEGATIVE AIR MACHINE
 - REMOVE APPROXIMATELY 3,200 SF OF VINYL WALL PAPER
 - INSPECT DRYWALL AND REMOVE DRYWALL WHERE NEEDED
 - INSTALL OBSERVATION HOLES IN SELECT LOCATIONS
 - REMOVE 8 CEILING TILES
 - SPRAY AND CLEAN WITH EPA APPROVED FUNGICIDE
- PHASE 3 - CORRIDOR AREA ROOMS 256-241**
- REMOVE 27 CEILING TILES
 - SPRAY AND CLEAN AREA WITH EPA APPROVED FUNGICIDE

LEGEND

- = SET UP EDGEGUARD AT ROOM ENTRANCE
- = REMOVE VINYL WALL PAPER
- = REMOVE WATER STAINED CEILING TILES WHERE APPROPRIATE

Stark Elementary School

City of Stamford

Stamford, CT

DRAFT

MARK	DATE	DESCRIPTION
PROJECT NO:	S2087	
DATE:	4/11/2019	
FILE:	Stark Mold Remediation2.dwg	
DRAWN BY:	WAC/BG	
CHECKED:	BS	
APPROVED:	XX	

2ND FLOOR CORRIDOR MOLD REMOVAL SCOPE OF WORK - AREA 9

SCALE: NOT TO SCALE

Figure 3.6

Plot Date: 4/11/2019
 Plot Time: 11:28am
 Plot Path: C:\Users\Bjorn.Bjorn\Documents\Projects\Stark Mold Remediation\Drawings\CAD\Stark Mold Remediation2.dwg
 Tighe & Bond: J:\S2087 - Stamford\1033 - Mold Remediation - Consulting\Stark\Drawings\CAD\Stark Mold Remediation2.dwg